



JOKER

www.joker.com.tw

Best

Your satisfaction is always our quality goal!

Quality



Since 1984 1991 1992 1994 1995 1998 1999 2000 2001 2002 2004 2008 2010 2014 2016 2017



Hollow Wall Anchor



Sleeve Anchor



Metal Frame Anchor



Metal Plug



Drop-InAnchor



Jack Nut



Spring Toggle



Wedge Anchor



Spring Pin



Safety Nail



New Fixing



Metal Insulation Plug



Light Concrete Nail



CB HWA



Hex Socket Head



Anchor Tool



Metal Single Expansion Anchor



Easy Anchor



Spendarl Anchor



Double Expansion Anchor



SISSY ANCHOR



SISSY STUD



SISSY STUD
ETA Approval



Sissy Stud



Hollow Wall Anchor



Express Nail



Sleeve Anchor



How about your choice

on everything?



Depend on what, then your choice could be succeeded in each time.
Can this ability extend to next generation of your life choice?
For example: your marriage and business partner...



• President:

Mr. Pang Ching Huang, president of Joker Industrial Co., Ltd., was born on the 15th of January, 1957 in Taiwan. He graduated from the Taiwan Institute Of Technology and mainly majored in molding and tooling R&D fields.

Dear Sirs:

Herein we are glad to introduce our new catalogue to you.

We wish that our wide range of products can meet your requirements.

For the past decade, every order is a confirmation and encouragement to our career.

We have been a good cooperater of world famous manufacturers for many years. Furthermore, we are ready to act as your partner to develop new products. We have different packing system to meet your different demands. Looking forward to receiving further more comments from you to boost business relation between you and JOKER.

• History of Joker Co., Ltd.:

In 1984, Mr. PangChing Huang established 340 Enterprise Co., Ltd. in Changhua, Taiwan, which was a professional factory for producing anchors and hardware OEM. After four years in business, the company was renamed as “Joker Industrial Company Limited” and now specializes in building anchors. Through the years, our market has expanded and reached Germany, France, Britain, U.S.A., and Japan. Now Joker is one of the main manufacturers for building anchors in Taiwan. We welcome customers’ samples and we can develop it for you.

• Scope of business:

Main export countries: Germany, France, Britain, USA, and Japan.

Yours truly
Pang Ching Huang



FACTORY AREA / Taiwan area: 20,000 square meters
Shanghai area: 15,000 square meters



07	Hollow Wall Anchor • Wuga Type	
09	Hollow Wall Anchor With Drive Hollow Wall Anchor With O.C.L.Screw Hooks 5.5 For Hollow Wall Anchor Hollow Wall Anchor Body Tool Fundamentool	
10	Hollow Wall Anchor CB TYPE Anchor Tool • CODE:1801 CODE:1802 CODE:1803	
11	Jack Nut New Fixing Easy Anchor	
12	Hammer Drive Anchor Nylon Hammer Fixing Nylon Frame Fixing Nylon Wall Plug Without Screw	
14	Express Nail (Spring Pin) Express Hanger Key Anchor	
15	Metal Insulation Plug • WASHER FOR INSULATION PLUG	
16	Light Concrete Nail Spendarl Anchor Safety Nail	
18	Sleeve Anchor J Type • WITH FLANGE NUT • WITH HEX BOLT • WITH HOOK AND EYE	
19	Suspension Anchor Metal Frame Anchor Double Expansion Anchor Plastic Cap For M10	
20	Metal Plug Metal Frame Screw (T25 and T30) Frame Fixing Screw	
22	SISSY STUD • Hex Head • Hex Washer Head	 
23	SISSY STUD • Countersunk Head T-30 • Round Head T-30 • Pan Head T-30 • Truss Head T-30	 
24	SISSY STUD • Hex Head • Hex Washer Head	
25	SISSY STUD • Countersunk Head T-30 • Round Head T-30 • Pan Head T-30 • Truss Head T-30	
26	SISSY STUD • Hex Socket Head • Double Head • (7.5) Hex Washer Head With Thread M8,M10 • C type O type • Tool for O.C type	
27	SISSY ANCHOR	



Hollow Wall Anchor

Wuga Type

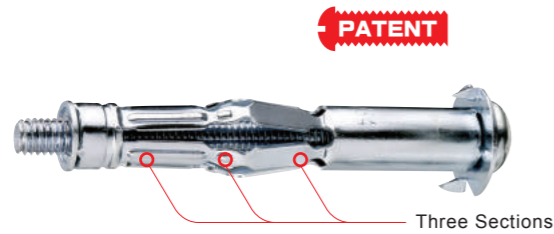

Strength distribute stably

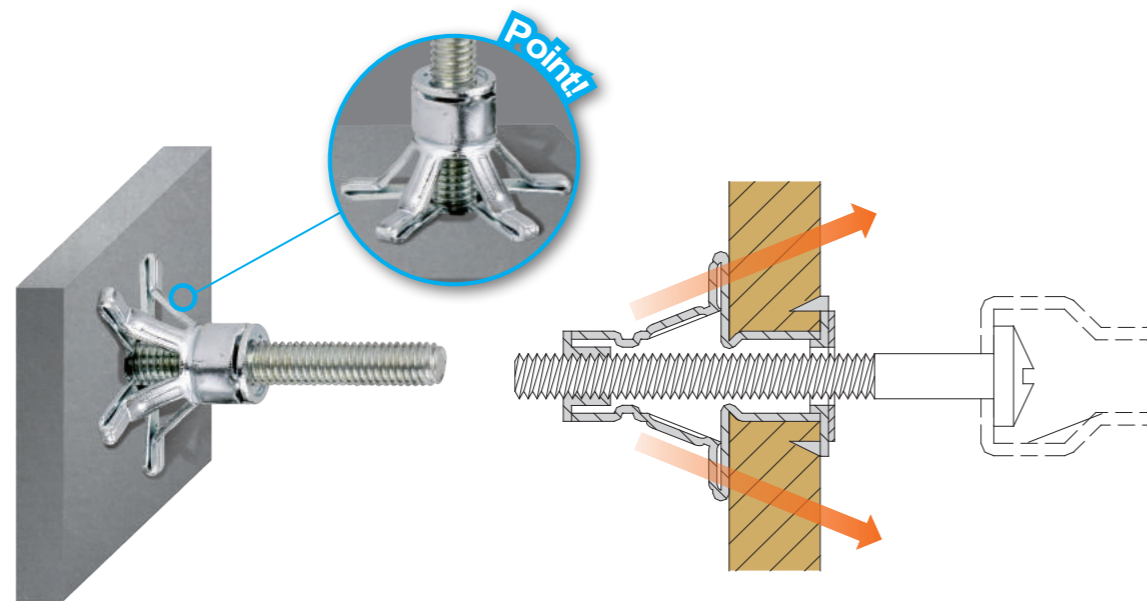

Conventional

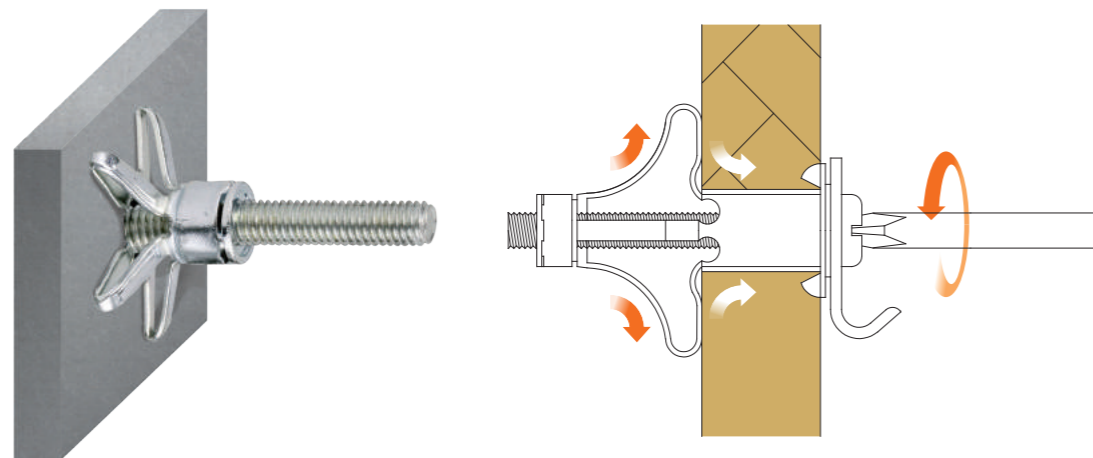

Hollow Wall Anchor Wuga Type

Feature:

- Three sections overlapping.
- Generates a bracing support of multiple sections.
- Prevent construction defect and damage of wall.
- To maximize load capacity.
- Anchor is still workable even though the ribs are dented.

CODE NO.	METRIC SIZE	INCH SIZE	ANCHOR LENGTH	DRILL Ø (mm)	GRIP RANGE (mm)	SCREW LENGTH
WG1001	4X21	1/8XS	23	8	UP~4	28
WG1002	4X32	1/8S	33	8	4~9	41
WG1412	4X36	-	37	8	6~13	43.5
WG1003	4X38	-	39	8	9~16	47
WG1004	4X46	1/8L	46	8	16~22	54
WG1005	4X54	-	54	8	18~28	61
WG1006	4X59	1/8XL	60	8	32~38	67
WG1007	5X37	-	37	10	5~13	43.5
WG1008	5X52	3/16S	53	10	5~18	60
WG1009	5X65	3/16L	65	10	18~32	74
WG1010	5X80	3/16XL	81	10	32~45	89
WG1011	6X37	-	37	12	5~13	45
WG1012	6X52	1/4S	53	12	5~18	60
WG1013	6X65	1/4L	66	12	18~32	74
WG1014	6X80	1/4XL	81	12	32~45	88
WG1015	8X37	-	39	14	5~13	45
WG1016	8X55	-	55	14	5~18	65
WG1017	8X65	-	68	14	18~32	75
WG1018	8X80	-	84	14	32~45	90

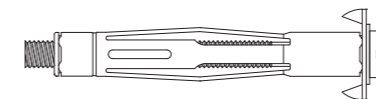

CODE NO.	ITEM NO.	SIZE	ANCHOR LENGTH	DRILL Ø (mm)	GRIP RANGE	SCREW	SCREW LENGTH
1104	422I	1/8SL	46	8	3-18	6#-32	54
1204	422M	4X46	46	8	3-18	4MM	54

Hollow Wall Anchor With Drive



CODE NO.	ITEM NO.	INCH SIZE	ANCHOR LENGTH	DRILLØ (mm)	GRIP RANGE (mm)	SCREW	SCREW LENGTH
1301	405 D	1/8XSD	23	8	UP-4	6#-32	35
1302	409 D	1/8SD	33	8	4-9	6#-32	46
1304	422 D	1/8SLD	46	8	3-18	6#-32	59
1305	423 D	1/8LD	46	8	16-21	6#-32	59

Hollow Wall Anchor With O.C.L.Screw



CODE NO.	SIZE	ANCHOR LENGTH	THREADLENGTH
1701	4X32-L	33	40
1702	4X32-C	33	40
1703	4X32-O	33	40
1704	5X37-L	37	45
1705	5X37-C	37	45
1706	5X37-O	37	45

Hooks 5.5 For Hollow Wall Anchor



CODE: HK01

Hollow Wall Anchor Body Tool



CODE: HT01

Fundamentool



PATENT

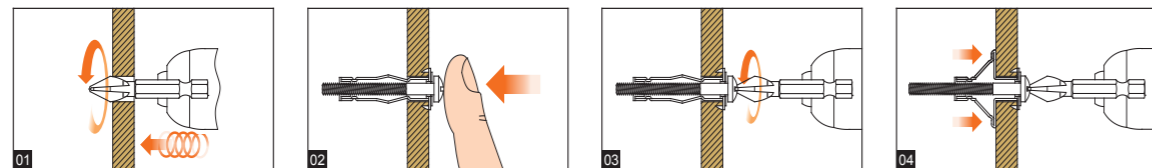
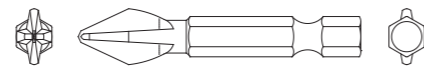

CODE NO.	SIZE	POZI	PHILLIPS	POWER TOOL	
				Code of Speed	Setting Torque
F001	M4	02	02	2	2
F002	M5	02	02	3	3
F003	M6	03	03	3	3
F004	1/8"	02	02	2	2
F005	3/16"	02	02	3	3
F006	1/4"	03	03	3	3

Hollow Wall Anchor CB TYPE

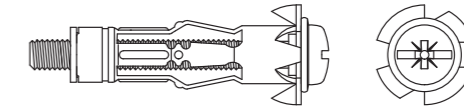

CODE NO.	ITEM NO.	SIZE	ANCHOR LENGTH	DRILL(mm)	GRIP RANGE(mm)	SCREW LENGTH
CB1001	409	4X32	32	8	4-9	41
CB1002	M4S	4X30	30	8	2-13	39
CB1003	M4M	4X35	35	8	4-18	44
CB1004	M4L	4X47	47	8	11-30	56
CB1005	M4XL	4X55	55	8	18-38	64
CB1006	510	5X37	37	10	5-13	45
CB1007	M5S	5X38	38	10	2-20	47
CB1008	M5M	5X55	55	10	7-32	64
CB1009	M5L	5X71	71	10	13-45	80
CB1010	M6S	6X38	38	12	2-20	47
CB1011	M6M	6X55	55	12	7-32	64
CB1012	M6L	6X71	71	12	13-45	80

Anchor Tool



CODE:1801



CODE:1802



CODE:1803



CODE:1804

Jack Nut



Carbon Steel
Stainless Steel
Available

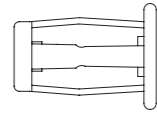

Jack Nut

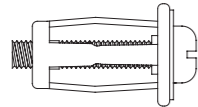

Jack Nut
With Screw

CODE NO.	SIZE	ANCHOR LENGTH	SCREW	GRIP RANGE(mm)
JN405	M4S	17	M4	0-5
JN410	M4L	22	M4	0-8
JN505	M5S	18	M5	0-5
JN510	M5L	23	M5	0-8
JN605	M6S	18	M6	0-5
JN610	M6L	23	M6	0-8
JN805	M8S	21	M8	0-5
JN810	M8L	25	M8	0-8
JI405	1/8S	17	6#-32	0-5
JI410	1/8L	22	6#-32	0-8
JI505	3/16S	18	10#-24	0-5
JI510	3/16L	23	10#-24	0-8
JI605	1/4S	18	1/4-20	0-5
JI610	1/4L	23	1/4-20	0-8
JI805	5/16S	21	5/16-18	0-5
JI810	5/16L	25	5/16-18	0-8

New Fixing

PATENT

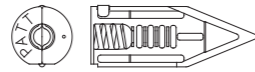
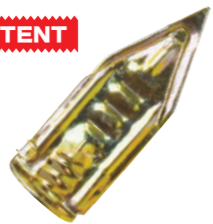

CODE NO.	LENGTH (mm)	chipboard screw diameter
NF4030	30	3.5~4.0
NF4036	36	3.5~4.0

Easy Anchor

PATENT

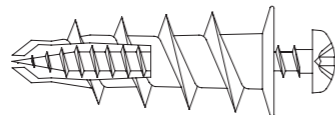

CODE NO.	LENGTH(mm)	CHIPBOARD SCREW DIAMETER
EA4028	28	4~4.5
EA4034	34	4~4.5

EA4028

EA4034

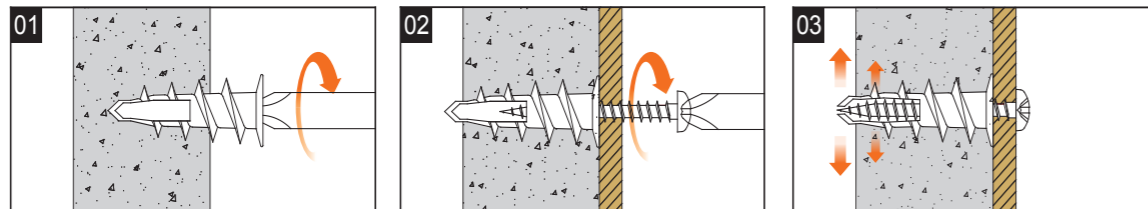

* PRODUCT ADVANTAGES

- Heat resistant
- Self-drilling Anchors for light fixings in gypsum, gypsum-carton-boards, gas-concrete, lime, chipboards, wood

Hammer Drive Anchor

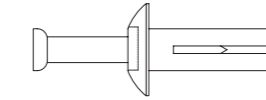

Steel Nail with
Zinc Aolly Shield

CODE NO.	HEAD STYLE	OUTSIDE DIAMETER	LENGTH UNDER HEAD
HD0522	ROUND	M5	22MM
HD0620	ROUND	M6	20MM
HD0630	ROUND	M6	30MM
HD0640	ROUND	M6	40MM
HD0650	ROUND	M6	50MM
HD0665	ROUND	M6	65MM
HI0522	ROUND	3/16"	7/8"
HI0620	ROUND	1/4"	3/4"
HI0625	ROUND	1/4"	1"
HI0632	ROUND	1/4"	1-1/4"
HI0638	ROUND	1/4"	1-1/2"
HI0650	ROUND	1/4"	2"

Nylon Hammer Fixing



CODE NO.	DXL	CODE NO.	DXL
NH01	5X30	NH09	8X60
NH02	5X50	NH10	8X80
NH03	6X40	NH11	8X100
NH04	6X50	NH12	8X120
NH05	6X60	NH13	8X140
NH06	6X70	NH14	8X160
NH07	8X40	NH15	10X80
NH08	8X50		

Nylon Frame Fixing



CODE NO.	DXL	CODE NO.	DXL
NF01	5X30	NF09	8X80
NF02	5X40	NF10	8X100
NF03	5X50	NF11	8X120
NF04	6X40	NF12	10X80
NF05	6X60	NF13	10X100
NF06	6X80	NF14	10X120
NF07	8X50	NF15	10X140
NF08	8X60	NF16	10X160

Nylon Wall Plug Without Lip



CODE NO.	ITEM NO	LENGTH(mm)	RECOMMENDED SAFE WORK LOAD (kgs)
NW01	S4	20	20
NW02	S5	25	30
NW03	S6	30	50
NW04	S7	37	65
NW05	S8	40	80
NW06	S10	50	120
NW07	S12	60	180
NW08	S14	70	280

Express Nail (Spring Pin)

PATENT

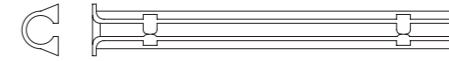

CODE NO.	DRILL(mm)	LENGTH(mm)	USABLE LENGTH(mm)
EN5026	5	26	3
EN5040	5	40	10
EN5050	5	50	20
EN6030	6	30	3
EN6040	6	40	10
EN6050	6	50	20
EN6060	6	60	30
EN6080	6	80	50
EN8050	8	50	10
EN8070	8	70	30
EN8090	8	90	50
EN8110	8	110	70
EN8130	8	130	90
EN8150	8	150	110
EN8180	8	180	140
EN8200	8	200	160

Express Hanger

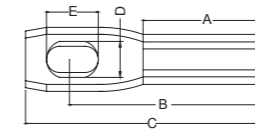

CODE NO.	DRILL(mm)	A(mm)	B(mm)	C(mm)	D(mm)	E(mm)
EH8042	8	22	34	42	5	10

Key Anchor

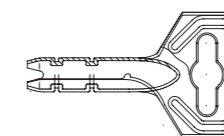

CODE NO.	SIZE	DRILL DIA (mm)	DRILL DEPTH (mm)
KA0832	8X32	8	30

Metal Insulation Plug

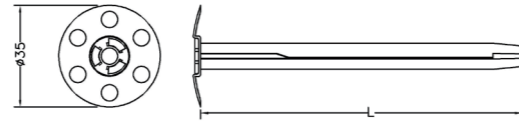

CODE NO.	SIZE	Total Length (mm)	Suitable For Insulation Material(mm)	Drill Ø (mm)	Min.Setting Depth (mm)
IP08040	8X40	40	0~10	8	30
IP08050	8X50	50	0~20	8	30
IP08060	8X60	60	0~25	8	35
IP08070	8X70	70	0~30	8	40
IP08080	8X80	80	0~30	8	50
IP08090	8X90	90	10~40	8	50
IP08100	8X100	100	20~50	8	50
IP08110	8X110	110	30~60	8	50
IP08140	8X140	140	60~90	8	50
IP08170	8X170	170	90~120	8	50
IP08200	8X200	200	120~150	8	50
IP08210	8X210	210	130~160	8	50
IP08240	8X240	240	160~190	8	50
IP08250	8X250	250	170~200	8	50
IP08300	8X300	300	220~250	8	50



Galvanized Steel
Stainless Steel
Available

WASHER FOR INSULATION PLUG

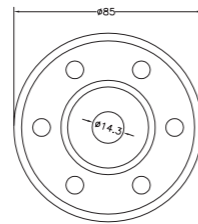
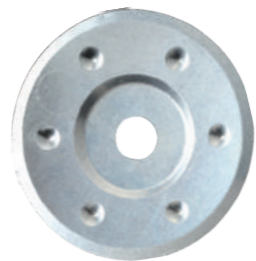

CODE NO.	Outside Dia. (mm)	Inside Dia. (mm)
WH01	85	14.5

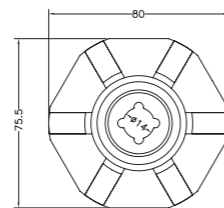

CODE NO.	Outside Dia. (mm)	Inside Dia. (mm)
WH02	80	14.5

Light Concrete Nail

PATENT

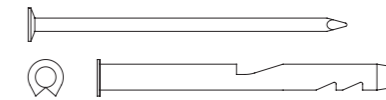

CODE NO.	SIZE	INSTALLATION DEPTH(mm)
CN08090	8X90	80
CN08115	8X115	80

Spendarl Anchor

PATENT



Carbon Steel
Stainless Steel
Available

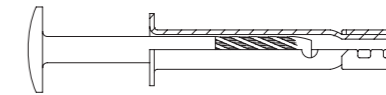

CODE NO.	SIZE	ANCHOR LENGTH(mm)	DRILL DEPTH	USABLE LENGTH	DRILL DIA
HB0630	M6X30	30	35	0-10	6
HB0640	M6X40	40	45	0-20	6
HB0660	M6X60	60	65	0-30	6
HB0840	M8X40	40	45	0-10	8
HB0860	M8X60	60	65	0-20	8
HB0880	M8X80	80	85	0-30	8
HB1050	M10X50	50	55	0-10	10
HB1070	M10X70	70	75	0-20	10
HB10100	M10X100	100	105	0-50	10

Safety Nail

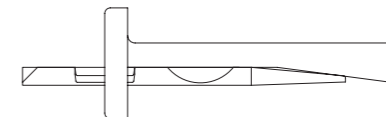

CODE NO.	PLUG AND DRILL(mm)	DRILLING DEPTH(mm)	FIXTURE THICKNESS (mm)
SN0640	6	40	5
SN0665	6	65	30

Sleeve Anchor J Type

WITH FLANGE NUT

PATENT

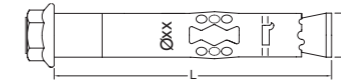

CODE NO.	SIZE	DRILL DIA	SCREW SIZE	LENGTH L	FASTENS MATERIAL UP TO(mm)
SA0625	6.5X25	6.5	M5	25	4
SA0636	6.5X36	6.5	M5	36	12
SA0656	6.5X56	6.5	M5	56	32
SA0840	8X40	8	M6	40	12
SA0865	8X65	8	M6	65	36
SA0885	8X85	8	M6	85	60
SA1040	10X40	10	M8	40	10
SA1050	10X50	10	M8	50	16
SA1060	10X60	10	M8	60	25
SA1075	10X75	10	M8	75	40
SA1095	10X95	10	M8	95	65
SA1260	12X60	12	M10	60	20
SA1275	12X75	12	M10	75	32
SA12100	12X100	12	M10	100	56
SA12130	12X130	12	M10	130	86
SA1665	16X65	16	M12	65	14
SA16110	16X110	16	M12	110	58
SA16145	16X145	16	M12	145	87
SA2075	20X75	20	M16	75	22
SA20105	20X105	20	M16	105	54
SA20150	20X150	20	M16	150	98



WITH HEX BOLT

PATENT

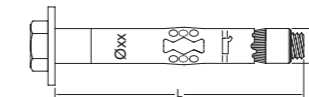

CODE NO.	SIZE	DRILL DIA	SCREW SIZE	LENGTH L	FASTENS MATERIAL UP TO(mm)
SH0845	8X45	8	M6	45	7
SH0860	8X60	8	M6	60	22
SH1060	10X60	10	M8	60	16
SH1080	10X80	10	M8	80	36
SH1270	12X70	12	M10	70	14
SH12100	12X100	12	M10	100	44



WITH HOOK AND EYE

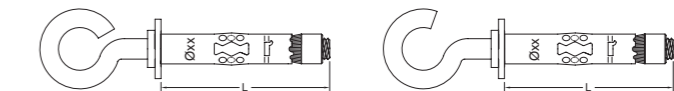

CODE NO.	SIZE	DRILL DIA	SCREW SIZE	LENGTH L	FASTENS MATERIAL UP TO(mm)
SH0840	8X40-C	8	M6	40	12
SH1050	10X50-C	10	M8	50	10
SB0840	8X40-O	8	M6	40	12
SB1050	10X50-O	10	M8	50	10



Suspension Anchor

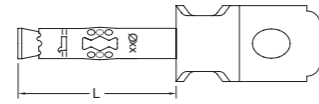

CODE NO.	SIZE	DRILL DIA	SCREW SIZE	LENGTH L	FASTENS MATERIAL UP TO(mm)
SU0625	6.5X25	6.5	M5	25	12
SU0635	6.5X35	6.5	M5	35	10

Metal Frame Anchor



CODE NO.	SIZE	DRILL	MIN.HOLE DRILL DEPTH(mm)	MAX.FIXING LENGTH(mm)
MF0872	8X72	8	40~50	42
MF0892	8X92	8	40~50	62
MF08112	8X112	8	40~50	82
MF08132	8X132	8	40~50	102
MF08172	8X172	8	40~50	142
MF1072	10X72	10	40~50	42
MF1092	10X92	10	40~50	62
MF10112	10X112	10	40~50	82
MF10132	10X132	10	40~50	102
MF10152	10X152	10	40~50	122
MF10182	10X182	10	40~50	152
MF10202	10X202	10	40~50	172

Double Expansion Anchor



CODE NO.	SIZE	DRILL	MIN.HOLE DRILL DEPTH(mm)	MAX.FIXING LENGTH(mm)
DE1092	10X92	10	40~50	62
DE10112	10X112	10	40~50	82
DE10132	10x132	10	40~50	102
DE10152	10X152	10	40~50	122
DE10182	10X182	10	40~50	152

Plastic Cap For M10



•FOR FLAT HEAD



•FOR TRUSS HEAD

Metal Plug

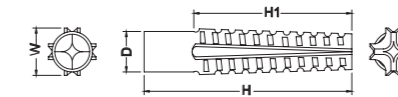

CODE NO.	SIZE	D±0.3	H±0.2	H1±1	W±0.5
MEP01	M5X30	6.5	30.3	25.0	7.5
MEP02	M6X32	7.2	32.3	21.0	8.5
MEP03	M8X38	9.6	38.1	31.0	11.5
MEP04	M8X60	9.8	60.3	46.0	11.5
MEP05	M10X60	11.6	60.6	46.0	14.0

Metal Frame Screw(T25 and T30)

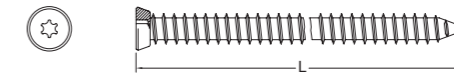

CODE NO.	SIZE	CODE NO.	SIZE
FR01	7.5X42	FR06	7.5X112
FR02	7.5X52	FR07	7.5X132
FR03	7.5X62	FR08	7.5X152
FR04	7.5X72	FR09	7.5X182
FR05	7.5X92	FR10	7.5X212

Frame Fixing Screw

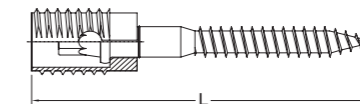

CODE NO.	SIZE	DRILLØA(mm)	DRILLØB(mm)	L
FS750	M7x50L	10	14	54
FS770	M7x70L	10	14	68
FS790	M7x90L	10	14	93
FS7140	M7x140L	10	14	138

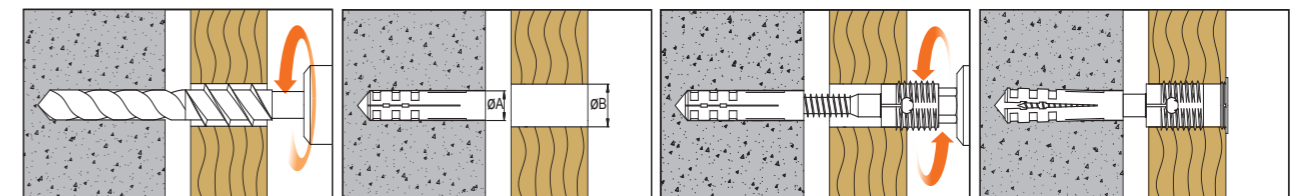



SISSY STUD **PATENT**

Hex Head

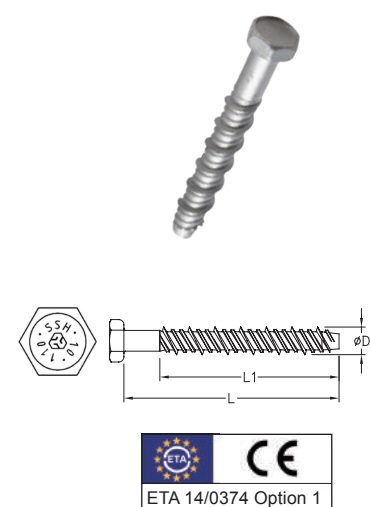

SIZE øDxL	Thread length(L1)	Drill diameter in concrete
7.5x60	50	6 Wrench size:10mm
7.5x80		
7.5x100		
7.5x120		
7.5x140		
10.5x70	60	8 Wrench size:13mm
10.5x80		
10.5x90		
10.5x100		
10.5x110		
10.5x120	70	10 Wrench size:15mm
10.5x130		
10.5x140		
12.5x80		
12.5x90		
12.5x100	80	14 Wrench size:18mm
12.5x120		
12.5x140		
12.5x160		
12.5x200		
16.5x130		
16.5x150		

Hex Washer Head



SIZE øDxL	Thread length(L1)	Drill diameter in concrete
7.5x60	55	6 Wrench size:10mm
7.5x80		
7.5x100		
7.5x120		
10.5x65	60	8 Wrench size:13mm
10.5x75		
10.5x90		
10.5x110		
10.5x130	70	10 Wrench size:15mm
12.5x75		
12.5x85		
12.5x100		
12.5x120		
12.5x140		
12.5x160		
12.5x200	110	14 Wrench size:18mm
16.5x115		
16.5x135		
16.5x160		

SISSY STUD **PATENT**

Countersunk Head T-30

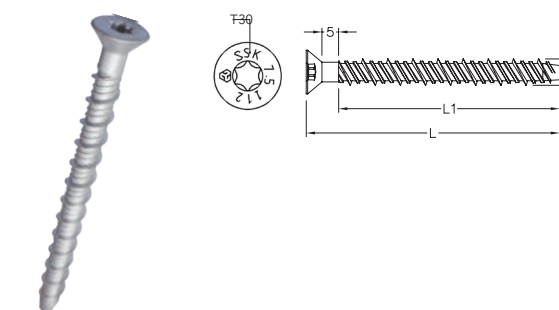

SIZE øDxL	Thread length(L1)	Drill diameter in concrete
7.5x72	Full thread	6
7.5x92		
7.5x112		
7.5x132		
7.5x152		
7.5x172		
7.5x192		

Pan Head T30

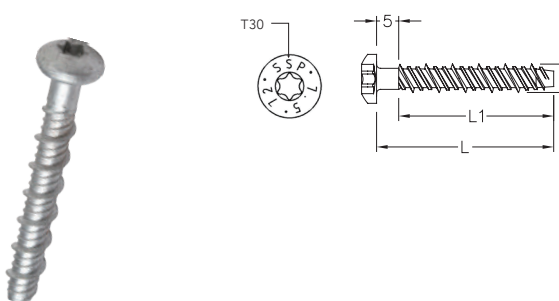

SIZE øDxL	Thread length(L1)	Drill diameter in concrete
7.5x72	Full thread	6

Round Head T-30

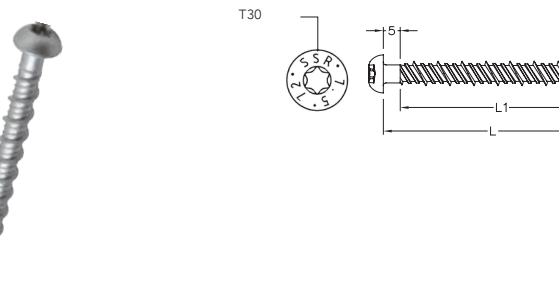

SIZE øDxL	Thread length(L1)	Drill diameter in concrete
7.5x65	Full thread	6
7.5x72		

Truss Head T-30

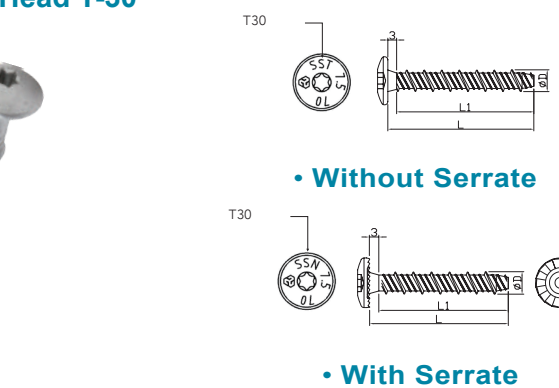

SIZE øDxL	Thread length(L1)	Drill diameter in concrete
7.5x60	Full thread	6
7.5x65		
7.5x70		
7.5x75		

Hex Head

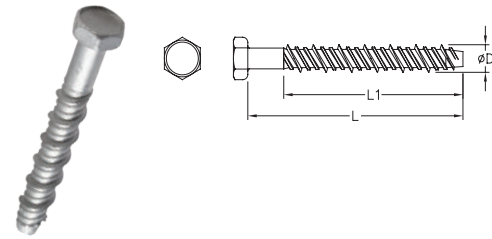

SIZE øDxL	Thread length(L1)	Drill diameter in concrete
6.3x40	Full thread	5 Wrench size: 8mm
6.3x50	40	
6.3x60		
6.3x80	Full thread	6 Wrench size: 10mm
6.3x100		
7.5x35	50	6 Wrench size: 10mm
7.5x40		
7.5x45	Full thread	8 Wrench size: 13mm
7.5x50		
7.5x60	60	8 Wrench size: 13mm
7.5x80		
7.5x100	Full thread	10 Wrench size: 15mm
7.5x120		
7.5x140	70	10 Wrench size: 15mm
10.5x50		
10.5x60	Full thread	12 Wrench size: 16mm
10.5x70		
10.5x80	80	14 Wrench size: 18mm
10.5x90		
10.5x100	Full thread	14 Wrench size: 18mm
10.5x110		
10.5x120	80	14 Wrench size: 18mm
10.5x130		
10.5x140	Full thread	14 Wrench size: 18mm
12.5x60		
12.5x80	80	14 Wrench size: 18mm
12.5x90		
12.5x100	Full thread	14 Wrench size: 18mm
12.5x120		
12.5x140	80	14 Wrench size: 18mm
12.5x160		
12.5x200	Full thread	14 Wrench size: 18mm
14.2x80		
14.2x110	80	14 Wrench size: 18mm
14.2x130		
14.2x150	Full thread	14 Wrench size: 18mm
16.5x110		
16.5x130	80	14 Wrench size: 18mm
16.5x150		
16.5x160	Full thread	14 Wrench size: 18mm
16.5x115		
16.5x135	80	14 Wrench size: 18mm
16.5x150		
16.5x160	Full thread	14 Wrench size: 18mm

Hex Washer Head

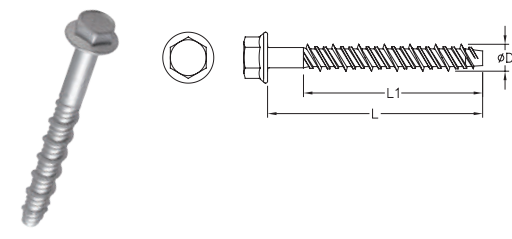

SIZE øDxL	Thread length(L1)	Drill diameter in concrete
6.3x50	40	5 Wrench size: 8mm
6.3x60		
7.5x35	Full thread	6 Wrench size: 10mm
7.5x45		
7.5x60	55	6 Wrench size: 10mm
7.5x80		
7.5x100	60	8 Wrench size: 13mm
7.5x120		
10.5x55	Full thread	8 Wrench size: 13mm
10.5x65		
10.5x75	60	8 Wrench size: 13mm
10.5x90		
10.5x110	Full thread	10 Wrench size: 15mm
12.5x65		
12.5x75	70	10 Wrench size: 15mm
12.5x85		
12.5x100	80	12 Wrench size: 16mm
12.5x120		
12.5x140	80	12 Wrench size: 16mm
12.5x160		
12.5x200	Full thread	12 Wrench size: 16mm
14.2x90		
14.2x110	80	12 Wrench size: 16mm
14.2x130		
14.2x150	Full thread	14 Wrench size: 18mm
16.5x80		
16.5x115	80	14 Wrench size: 18mm
16.5x135		
16.5x160	Full thread	14 Wrench size: 18mm

Countersunk Head T-30

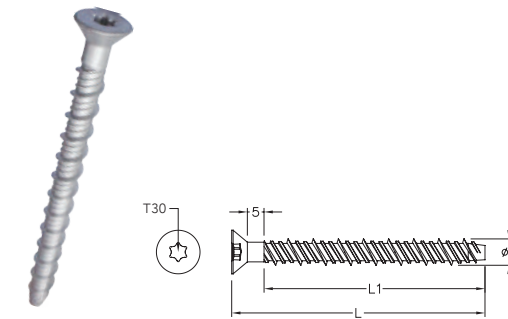

SIZE øDxL	Thread length(L1)	Drill diameter in concrete
7.5x42	Full thread	6
7.5x72		
7.5x92		
7.5x112		
7.5x132		
7.5x152		
7.5x172		
7.5x192		

Pan Head T-25 T-30

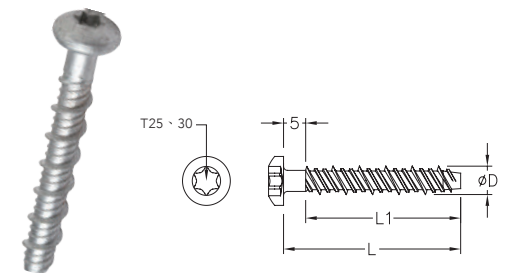

SIZE øDxL	Thread length(L1)	Drill diameter in concrete
6.3x30	Full thread	5
6.3x40		
6.3x50		
6.3x60	Full thread	6
7.5x42		
7.5x50		
7.5x72	Full thread	6

Round Head T-30

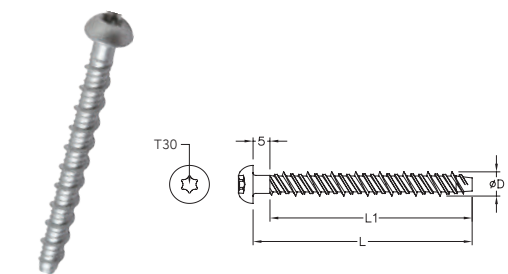

SIZE øDxL	Thread length(L1)	Drill diameter in concrete
7.5x42	Full thread	6
7.5x65		
7.5x72		

Truss Head T-30

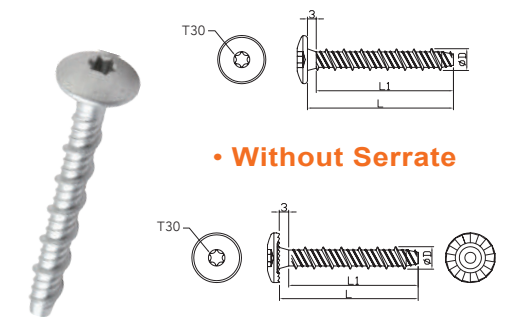

• Without Serrate

• With Serrate

SIZE øDxL	Thread length(L1)	Drill diameter in concrete
7.5x35	Full thread	6
7.5x40		
7.5x45		
7.5x50		
7.5x55		
7.5x60		
7.5x65		
7.5x70		
7.5x75		

ROD Hanging Type

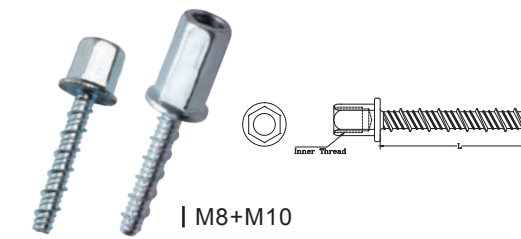

Internal Thread Size	Thread size DxL	Drill diameter in concrete	SW
M6	6.3x50	5	8
M8	7.5x50	6	10
M10	7.5x50	6	13
M8+M10	7.5x40	6	13

Double Thread Type

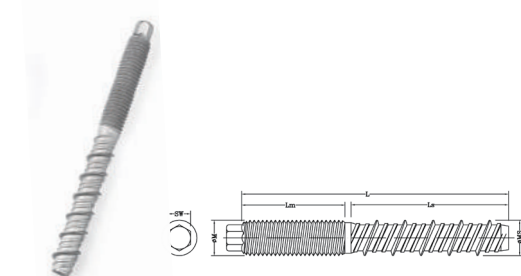

SIZE MxL	Thread(M) xlength(LM)	Thread(MS) xlength(LS)	Drill diameter in concrete	SW (mm)
M6x1.0x60	M6x20	6.3x40	5 mm	4
M8x1.25x80	M8x25	7.5x55	6 mm	5
M10x1.5x100	M10x40	10.5x60	8 mm	7
M12x1.75x125	M12x55	12.5x70	10 mm	8

(7.5) Hex Washer Head With Thread M8,M10

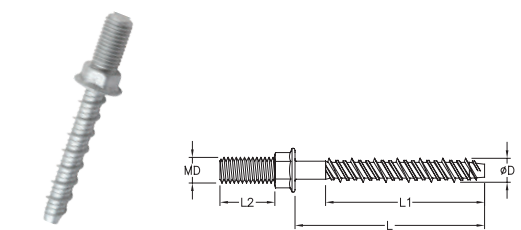

SIZE øDxL	Thread length(L1)	Drill diameter in concrete
7.5x50-M8/18	Full thread	6 (Wrench size:10mm)
7.5x65-M8/18		
7.5x50-M10/21		
7.5x80-M10/21		

O.C type



TYPE	SIZE D*L	Drill diameter in concrete
C TYPE	6.3x40	5
O TYPE	6.3x40	5

Tool for O.C type

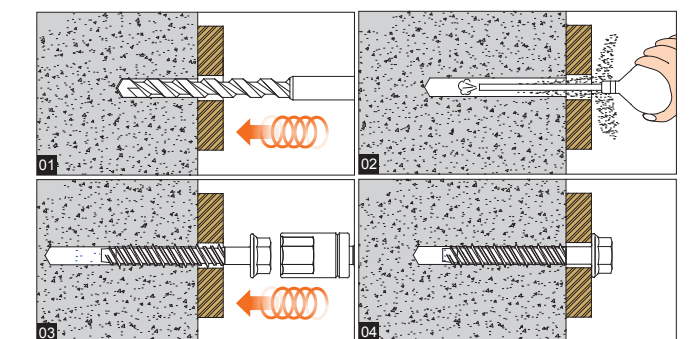

ETA Approval



Sissy Stud

SISSY ANCHOR

Screw-In Screw System

Producer:
Joker Industrial Taiwan

Program	
Metric	inch
M5 x 28	
M6 x 28	1/4" x 1-1/16"
M8 x 32	5/16" x 1-1/4"
M10 x 37	3/8" x 1-7/16"
M12 x 42	1/2" x 1-11/16"
M16 x 43	5/8" x 1-11/16"



A sensational anchor!



Sissy Anchor with Ruspert coating												
size		M5	M6	M8	M10	M12	M16	1/4"	5/16"	3/8"	1/2"	5/8"
drill bit (Bohrer)	mm	8	9	12	15	18	22	3/8"	1/2"	9/16"	11/16"	27/32"
hole depth (Bohrlochtiefe)	mm	33	33	37	42	47	48	33	38	43	48	49
SISSY length (SISSY länge)	mm	28	28	32	37	42	43	1-1/16"	1-1/4"	1-7/16"	1-11/16"	1-11/16"
screw (Schrauben)	metric	M5	M6	M8	M10	M12	M16	1/4"	5/16"	3/8"	1/2"	5/8"
allen key (Imbuß) wrench	mm	5	6	8	10	12	16	1/4"	5/16"	3/8"	1/2"	5/8"
setting torque (Enschraubmoment)	Nm	5-10	5-10	15	20	20	50	5-10	15	20	20	50



•World newest fastener

SHK > Installation technology
Electro > Assembly, fire proof
Metal > Fixation of crash barriers
Wood > Add additional installations
Applications for all target customers !

•Unlimited application possibilities

•SISSY Know How safe guarding

PCT Patent-applied
EU, USA, CDA, JP, CN, SWISS, etc.

SISSY ANCHOR

•For all solid base materials



•Beton



•Holz



•Ziegel



•Fastening without tension force

short distances anchor to anchor and anchor to edge



• Safety fastening in tension zones

Undercut-Technology

• Pull out load increase setting depth Setting in a go-through hole

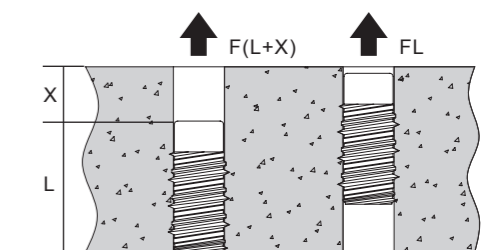

•Flexibility in thread length

Go through thread (important for Quick-Lock)



• Easy thread finding hexagon guiding

• Interim's applications

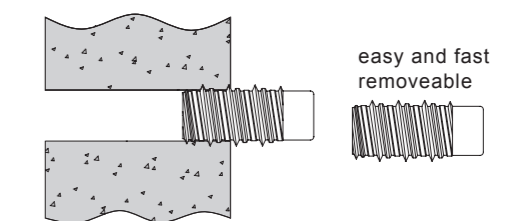

• Approvals (ETA, IfBt, ICBO)

1. Tension zone (under cut technology)
2. Pressure zone
3. Fire proof (alternativ plastic anchors)



• Simple – and fast application (no special tools needed)

